

The reproduction, distribution and utilization of this document as well as the communication of its contents to others without explicit authorization is prohibited. Offenders will be held liable for the payment of damages. All rights reserved in the event of the grant of a patent, utility model or design.

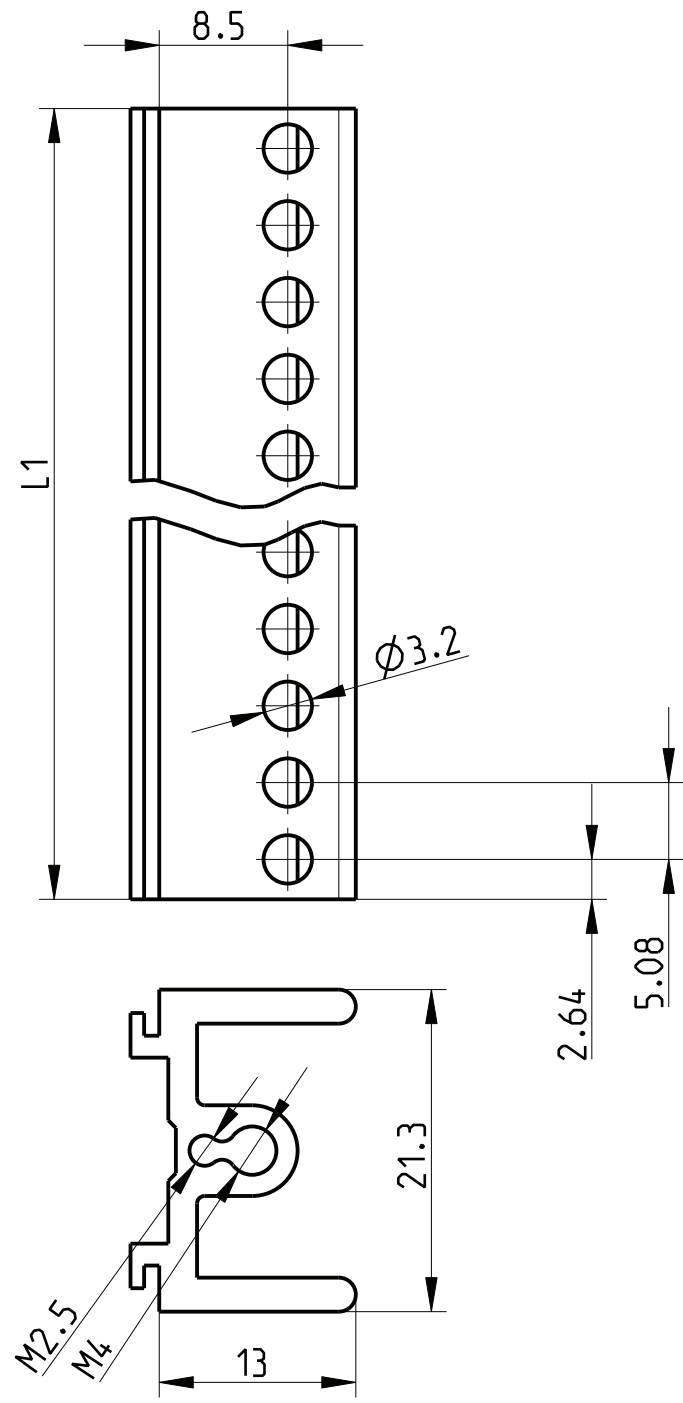

1) matt gebeizt, farblos chromatiert
Clear chromated

2) Standardprodukt: alle weiteren Typen auf Anfrage
Standard product: all other types on request

3) Technische Aenderungen vorbehalten
Subject to change without notice

Dieses Bauteil unterliegt den Reglementierungen der RoHS Richtlinie und deren Umsetzung im ElektroG.

This component is subject to the RoHS directive and its applications within the Electrical and Electronic Equipment Act (ElektroG).

Art.Nr.	Zeichnungs Nr.		Art.Nr.	Zeichnungs Nr.		
Part No.	Drawing No.	L1	Part No.	Drawing No.	L1	
2) 3684584	226 203.0455.00	858.72	2) 3686005	226 203.0455.50	259.28	
	226 203.0455.01	10.36		226 203.0455.51	264.36	
	226 203.0455.02	15.44		226 203.0455.52	269.44	
	226 203.0455.03	20.52		226 203.0455.53	274.52	
	226 203.0455.04	25.60		226 203.0455.54	279.60	
	226 203.0455.05	30.68		226 203.0455.55	284.68	
	226 203.0455.06	35.76		226 203.0455.56	289.76	
	226 203.0455.07	40.84		226 203.0455.57	294.84	
	226 203.0455.08	45.92		226 203.0455.58	299.92	
	226 203.0455.09	51.00		226 203.0455.59	305.00	
	226 203.0455.10	56.08		226 203.0455.60	310.08	
	226 203.0455.11	61.16		226 203.0455.61	315.16	
	2) 3684587	226 203.0455.12		66.24	226 203.0455.62	320.24
		226 203.0455.13		71.32	226 203.0455.63	325.32
		226 203.0455.14		76.40	226 203.0455.64	330.40
	2) 3684588	226 203.0455.15		81.48	226 203.0455.65	335.48
226 203.0455.16		86.56	226 203.0455.66	340.56		
226 203.0455.17		91.64	226 203.0455.67	345.64		
2) 3684589	226 203.0455.18	96.72	226 203.0455.68	350.72		
	226 203.0455.19	101.80	226 203.0455.69	355.80		
	226 203.0455.20	106.88	226 203.0455.70	360.88		
2) 3684964	226 203.0455.21	111.96	2) 3684591	226 203.0455.71	365.96	
	226 203.0455.22	117.04		226 203.0455.72	371.04	
	226 203.0455.23	122.12		226 203.0455.73	376.12	
	226 203.0455.24	127.20		226 203.0455.74	381.20	
	226 203.0455.25	132.28		226 203.0455.75	386.28	
	226 203.0455.26	137.36		226 203.0455.76	391.36	
	226 203.0455.27	142.44		226 203.0455.77	396.44	
	226 203.0455.28	147.52		226 203.0455.78	401.52	
	226 203.0455.29	152.60		226 203.0455.79	406.60	
	226 203.0455.30	157.68		226 203.0455.80	411.68	
	226 203.0455.31	162.76		226 203.0455.81	416.76	
	226 203.0455.32	167.84		226 203.0455.82	421.84	
	226 203.0455.33	172.92		226 203.0455.83	426.92	
	226 203.0455.34	178.00		226 203.0455.84	432.00	
	226 203.0455.35	183.08		226 203.0455.85	437.08	
	226 203.0455.36	188.16		226 203.0455.86	442.16	
226 203.0455.37	193.24	226 203.0455.87	447.24			
226 203.0455.38	198.32	226 203.0455.88	452.32			
226 203.0455.39	203.40	226 203.0455.89	457.40			
226 203.0455.40	208.48	226 203.0455.90	462.48			
226 203.0455.41	213.56	226 203.0455.91	467.56			
226 203.0455.42	218.64	226 203.0455.92	472.64			
226 203.0455.43	223.72	226 203.0455.93	477.72			
226 203.0455.44	228.80	226 203.0455.94	482.80			
226 203.0455.45	233.88	226 203.0455.95	487.88			
226 203.0455.46	238.96	226 203.0455.96	492.96			
226 203.0455.47	244.04					
226 203.0455.48	249.12					
226 203.0455.49	254.20					

	Toleranzen tolerances		Oberfläche surface 1)		Maßstab/scale 1:1	
					Aluminium	
			Date	09.01.96	Adapterschiene Adapter rail	
			Name	Kör./Frö		
b	HT0120	27.05.13	Kör.	Prf.	Schaffer	1 Blätter sheets
a	R269	22.04.05	Vish			
Rev.	Rev no.	Date	Name	HEITEC		Blatt sheet
						1
						226 203.0455.00-96 MB b

CAD