

The reproduction, distribution and utilization of this document as well as the communication of its contents to others without explicit authorization is prohibited. Offenders will be held liable for the payment of damages. All rights reserved in the event of the grant of a patent, utility model or design.

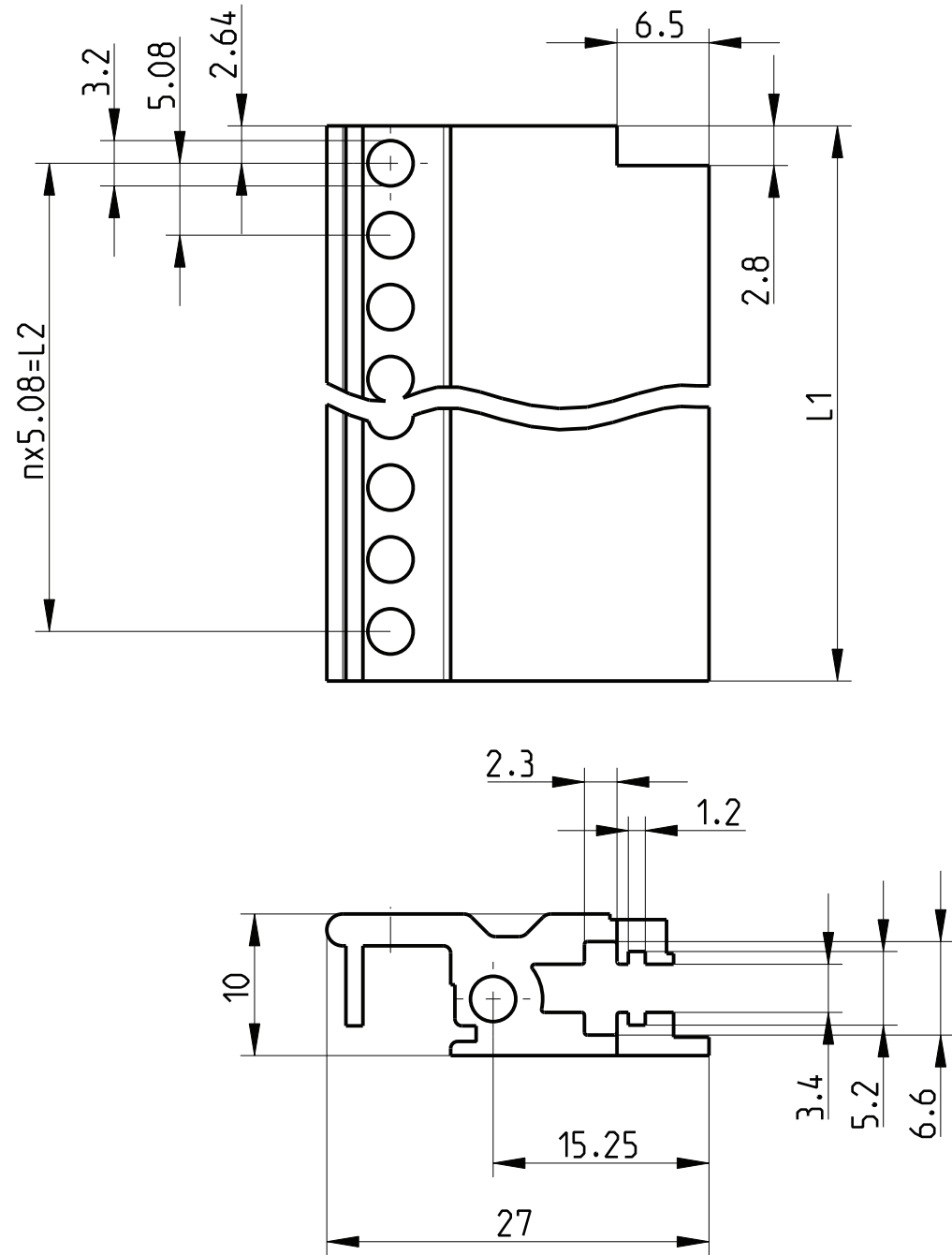

Art.Nr.	Zeichnungs Nr.	L1	L2	n
Part No.	Drawing No.			
	226 203.0491.01	6.14	0	0
	226 203.0491.02	11.22	5.08	1
	226 203.0491.03	16.30	10.16	2
2) 3684592	226 203.0491.04	21.38	15.24	3
	226 203.0491.05	26.46	20.32	4
	226 203.0491.06	31.54	25.40	5
	226 203.0491.07	36.62	30.48	6
2) 3684593	226 203.0491.08	41.70	35.56	7
	226 203.0491.09	46.78	40.64	8
	226 203.0491.10	51.86	45.72	9
	226 203.0491.11	56.94	50.8	10
	226 203.0491.12	62.02	55.88	11
	226 203.0491.13	67.10	60.96	12
	226 203.0491.14	72.18	66.04	13
	226 203.0491.15	77.26	71.12	14
	226 203.0491.16	82.34	76.20	15

- 1) matt gebeizt, farblos chromatiert
Clear chromated
- 2) Standardprodukt: alle weiteren Typen auf Anfrage
Standard product: all other types on request
- 3) Technische Aenderungen vorbehalten
Subject to change without notice

Dieses Bauteil unterliegt den Reglementierungen der RoHS Richtlinie und deren Umsetzung im ElektroG.

This component is subject to the RoHS directive and its applications within the Electrical and Electronic Equipment Act (ElektroG).

CAD

	Toleranzen tolerances		Oberfläche surface 1)		Maßstab/scale 2:1		1 Blätter sheets Blatt sheet 1
					Aluminium		
			Date	30.04.05	Schiene V/H links Rail V/H Left		
			Name	Vishwa			
			Prf.	Schaffer			
a	HT0120	27.05.13	K&r.	HEITEC		226 203.0491.01-16 MB a	
Rev.	Rev no.	Date	Name				