

single part no.: 3688782
 kit no.: 3688784
 Handle Typ VII top
 without offset

single part no.: 3688778
 kit no.: 3688780
 Handle Typ VII top
 with 2.54 mm offset

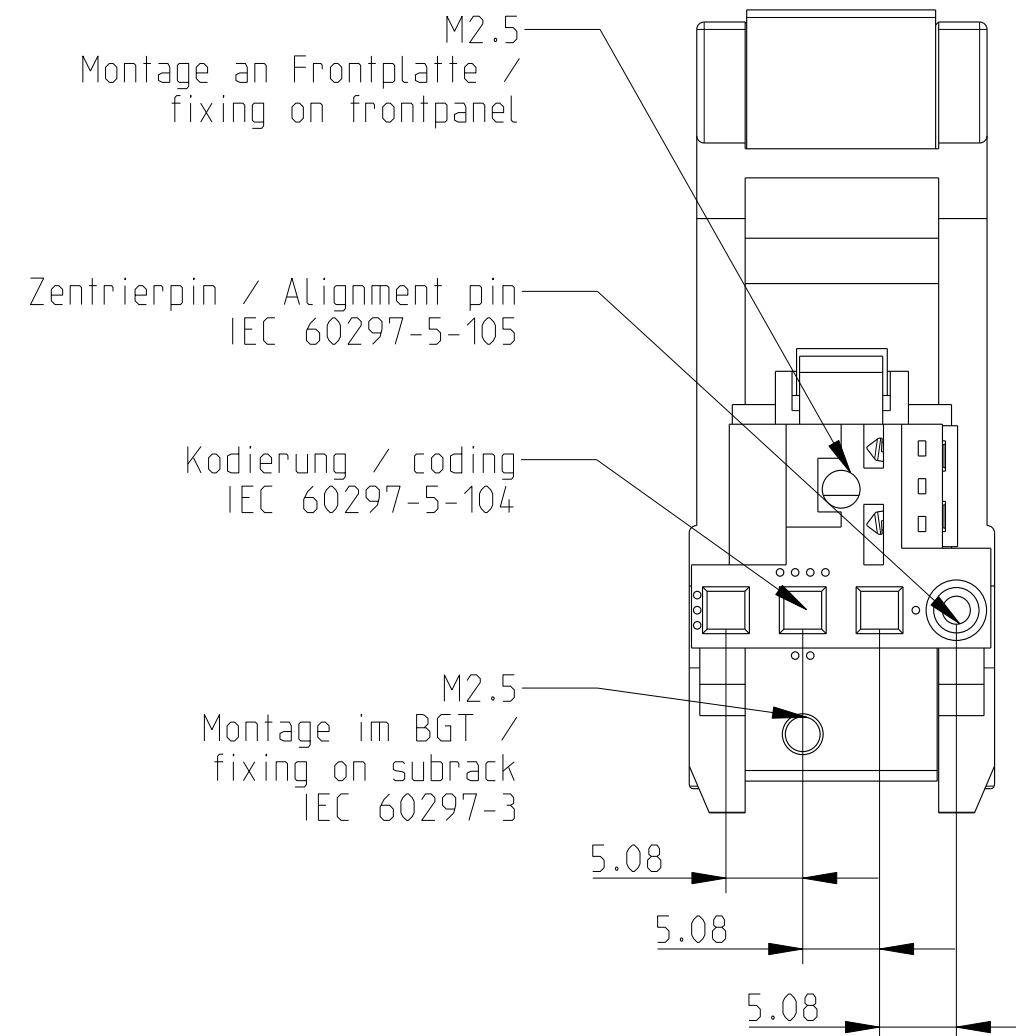

M2.5
 Montage an Frontplatte /
 fixing on frontpanel

Zentrierpin / Alignment pin
 IEC 60297-5-105

Kodierung / coding
 IEC 60297-5-104

M2.5
 Montage im BGT /
 fixing on subrack
 IEC 60297-3

Mikroschalter / microswitch (optional)

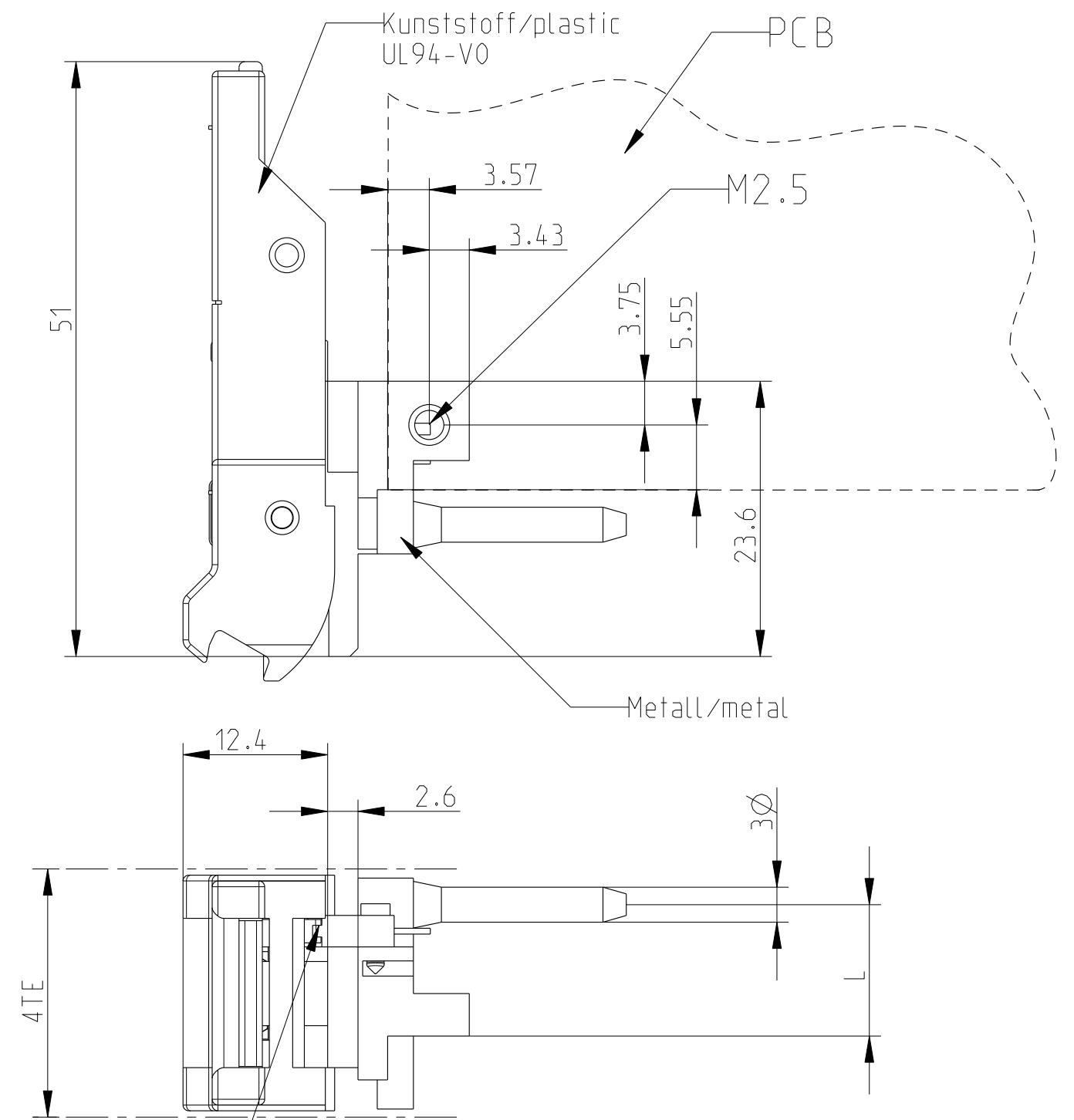

Part. No.:	Part. No.	Drawing No.:	L	Offset
single part	kit			
3688782	3688784 1)	M000	13.71	no
3688778	3688780 1)	M001	11.17	yes

(A2)

The reproduction, distribution and utilization of this document as well as the communication of its contents to others without explicit authorization is prohibited. All rights reserved in the event of a patent, utility model or design.

1) Standardprodukt: alle weiteren Typen auf Anfrage
 standard product: all other types on request

2) Technische Änderungen vorbehalten
 subject to change without notice

Dieses Bauteil unterliegt den Reglementierungen der RoHS Richtlinie und deren Umsetzung im ElektroG.

This component is subject to the RoHS directive and its applications within the Electrical and Electronic Equipment Act (ElektroG).

CAD

	Toleranzen tolerances		Oberfläche surface_		Maßstab/scale 2:1	
			---		Zinkdruckguß / Zinc die cast	
A4	HT0120	25.02.14	Kör.	Date	13.01.04	Griff Typ VII oben Handle Type VII top Kunststoff/Plastics J31815-V0166-M000_M001-A4-0027
A3	R489	25.10.06	FroS	Name	Kör./FroS	
A2	R215	28.01.04	FroS	Prf.	Schaff.	
Rev.	Rev no.	Date	Name	HEITEC		1 Blätter sheets Blatt sheet